

Leon Environmental Services

Richard "Danny" Leon CAC # 04-3708
Tommy Leon CAC # 05-3882

March 11, 2014

Wes Isaac
Wes Isaac Construction
1805 8th Street
Reedley, CA

**Re: Asbestos Survey Report
Old Cold Storage Building Behind Reedley City Hall
845 G Street, Reedley, CA
Job No. S25-14**

Dear Wes,

Attached is the asbestos survey report for the above referenced site. The report includes inspection observations, a list of all samples taken, bulk sample analysis results, a sample location diagram and recommendations concerning asbestos containing materials identified at this site.

If you have any questions or need additional information, please do not hesitate to call. Thank you for using Leon Environmental Services. We look forward to working with you in the future.

Respectfully yours,

Richard "Danny" Leon

Digitally signed by Richard "Danny" Leon
DN: cn=Richard "Danny" Leon, o=5592749200, ou,
email=leonenviro@comcast.net, c=US
Date: 2014.03.10 17:58:39 -07'00'

Richard "Danny" Leon
Certified Asbestos Consultant
Certification No. 04-3708

Leon Environmental Services

BUILDING DESCRIPTION

On Tuesday, February 25, 2014, an asbestos survey was performed on the Cold Storage Building behind Reedley City Hall, **845 G Street, Reedley, CA**, for Wes Isaac Construction. The building is a very large warehouse and storage building that is approximately 53,000 square feet and 60-80 years old. The structure has been added onto multiple times since the original construction. It has offices in the far west end, a large warehouse/garage area, large storage rooms on the east end, and a loading dock. The floor throughout is concrete, with some areas of vinyl floor tile in the west offices and the east dock entry. The walls are mainly plaster and concrete with only some sheetrock located in the break room and restrooms on the far west side of the building. The roof of the building is divided into several large areas, including one large barrel roof on the west end, and metal roofing on the majority of the building. The building also has stucco plaster exterior and interior walls.

ASBESTOS ANALYSIS RESULTS

All bulk samples of suspect asbestos containing materials were taken in accordance with US EPA Guidelines and accepted industry standards by a state certified asbestos consultant. Western Analytical Laboratory, Inc., a NVLAP accredited laboratory performed a total of 73 analyses from 71 samples of suspect ACM collected from the structures at this site. The samples listed on the following table are positive for asbestos. The full list of all samples taken is on the following pages. Sample locations are indicated on the diagrams included with this report. Quantities listed are estimates, for sampling purposes only, and should be verified prior to asbestos abatement.

| # | Location | Material | % | Friable | Sq. Ft. |
|-----|---------------------------------------|---------------------------------|-----|---------|-------------|
| 01 | Main Detective Office | Dark 12x12 Floor Tile | >1 | No | 374 |
| 02 | Main Detective Office | Black Mastic | 3-4 | No | See #01 |
| 04 | North Detective Office | Brown 9x9 Floor Tile | >1 | No | 234 |
| 06 | South Detective Office | Grey 9x9 Floor Tile | >1 | No | 256 |
| 37 | Cold Storage Rm 2 | Texture on Foam | 2 | Yes | 20,000 |
| 38 | Cold Storage Rm 2 | Texture on Foam | 2 | Yes | See #37 |
| 39 | Cold Storage Rm 3 | Texture on Foam | 2 | Yes | See #37 |
| 40 | Cold Storage Rm 3 | Texture on Foam | 2 | Yes | See #37 |
| 41 | Cold Storage Rm 1 | Texture on Foam | 2 | Yes | See #37 |
| 67a | West Barrel Roof, Remaining Layers | Roofing Felts, Bottom Layers | 40 | No | 16,000 |
| 67b | West Barrel Roof, Remaining Layers | Roofing Felts, Bottom Layers | 40 | No | See #67a |
| 68 | West Barrel Roof | Roof Mastic | 10 | No | 100 |

| |
|------------------------------|
| COMMENTS AND RECOMMENDATIONS |
|------------------------------|

The dark 12x12 floor tile (sample 01) and associated black mastic (sample 02) in the main detective office are positive for asbestos at greater than 1% and 3-4% respectively by weight. Floor tile and floor tile mastics are considered **non-hazardous non-friable ACM** and can be disposed of as construction waste in most cases after properly being abated. Leon Environmental Services recommends that a licensed asbestos abatement contractor remove this material prior to renovation and or demolition of this structure. **374 sq ft**

The brown 9x9 floor tile (sample 04) under the carpet in the north detective office, and the grey 9x9 floor tile (sample 06) in the south detective office are both positive for asbestos at greater than 1% by weight. The associated mastics for these VAT's are negative for asbestos. Floor tile is considered **non-hazardous non-friable ACM** and can be disposed of as construction waste in most cases after properly being abated. Leon Environmental Services recommends that a licensed asbestos abatement contractor remove these materials prior to renovation and or demolition of this structure. **490 sq ft**

NOTE: If floor tile and or floor tile mastics / adhesives are to be abated by mechanical methods, they then become **friable hazardous waste** and must be handled and disposed of accordingly.

The plaster-like texture on the spray foam (samples 37, 38, 39, 40, 41) on the walls & ceilings in cold storage rooms 2 & 3 and the ceiling in cold storage room 1 is positive for asbestos at 2% by weight. This material is considered **friable hazardous ACM** and must be handled and disposed of accordingly. Leon Environmental Services recommends that a licensed asbestos abatement contractor removes these materials prior to renovation and or demolition of this structure. **20,000 sq ft**

The bottom layers of roofing felts (samples 67a, 67b) on the on the west barrel roof are positive for asbestos at 40% by weight. Roofing materials are considered **non-hazardous non-friable ACM** and can be disposed of as construction waste in most cases after properly being abated. It is recommended that a licensed asbestos abatement contractor remove these materials prior to renovation and or demolition of this structure. **16,000 sq ft**

NOTE: The top layers of roofing on the barrel roof and the roofing on the flat roof are negative for asbestos.

The roof mastic (sample 68) on the seams and vents of the west barrel roof is positive for asbestos 10% by weight. Roof mastic and sealants are considered **non-hazardous non-friable ACM** and can be disposed of as construction waste in most cases after properly being abated. It is recommended that a licensed asbestos abatement contractor remove this material prior to renovation and or demolition of this structure. **100 sq ft**

CONCLUSIONS AND REGULATIONS

US EPA NESHAP 40 CFR Part 61

Based on our survey, sampling and subsequent laboratory analysis and regulatory guidelines affecting this site, the types of ACM identified on the previous page require removal (in most cases) prior to demolition and/or renovation procedures to comply with local, state and federal agencies. The US EPA NESHAP 40 CFR Part 61 requires materials containing greater than one percent asbestos by weight be removed prior to renovation or demolition.

If those materials are friable or likely to become friable due to the forces expected to act upon them during renovation or demolition, they become a regulated asbestos containing material (RACM) and require a 10-day notification to the local Air Pollution Control District prior to abatement. Non-friable and non-regulated ACM, in most cases, may be disposed of as construction debris in a landfill that accepts ordinary construction debris. **All friable waste containing more than 1% asbestos (RACM) should be manifested as hazardous waste for disposal purposes.**

CAL OSHA-----Construction Industry-----8CCR, 1529

The construction industry standard covers employees engaged in demolition and construction, and the following related activities likely to involve asbestos exposure: removal, encapsulation, alteration, repair, maintenance, insulation, spill emergency cleanup, transportation, disposal and storage of ACM. CAL OSHA worker health and safety regulations apply during any disturbance of ACM by a person while in the employ of another. This is true regardless of friability or quantity disturbed.

If there is greater than 100 square feet of ACM which will be affected by the demolition, a California Licensed Contractor who is registered with CAL OSHA for asbestos is required. The regulations regarding asbestos are found in Title 8 CCR Section 1529, and also include formal notification requirements to CAL OSHA at least 24 hours prior to removal. It is required that removal be conducted with the material kept in a wetted state to contain dust and hazardous emissions.

Demolition contractors typically require that a building owner/operator accept responsibility for removal of all ACM found during the building inspection prior to start of demolition activities.

| |
|--------------------------|
| LIMITATIONS OF LIABILITY |
|--------------------------|

Conclusions and recommendations presented in this report are qualitative judgments based on the prevailing regulations and accepted industry standards at the time of the report issuance. Leon Environmental Services provides no other guarantees, either expressed or implied. **All quantities of materials listed herein are estimates for sampling purposes only, and should be verified by owner representative or an abatement contractor prior to asbestos abatement.**

The nature of demolition and asbestos abatement is such that materials can be uncovered which previously were unknown to exist. Therefore, Leon Environmental Services cannot be responsible for materials not previously detected due to lack of accessibility or concealment, although every effort was made during the inspection to detect all suspect materials. **If any materials other than those included herein are discovered during renovation or demolition, it must be assumed that the materials are asbestos-containing, and should be treated accordingly until further testing and analysis is performed.**

The data interpretations and recommendations are based solely on information available to Leon Environmental Services at the time of our inspection. The customer recognizes that site conditions or accessibility may vary, from those encountered at the time of our inspection and sample collection. Varying conditions or access could result in additional information that would lead us to revise conclusions and recommendations. Leon Environmental Services will not be responsible for the interpretation or use by others of information contained within this report.

Richard "Danny" Leon

Digitally signed by Richard "Danny" Leon
DN: cn=Richard "Danny" Leon, o=5592749200, ou,
email=leonenviro@comcast.net, c=US
Date: 2014.03.10 17:59:46 -07'00'

Richard "Danny" Leon
Certified Asbestos Consultant
Certification No. 04-3708

DATE

***Abbreviation Key:**

Asbestos Containing Material – ACM (Contains greater than 1% asbestos by weight)
Asbestos Containing Building Material – ACBM (Contains less than 1% asbestos by weight)
Vinyl Asbestos Tile – VAT
No Asbestos Detected – N.A.D or N.D.
Homogeneous – H
Not Sampled – NS

Leon Environmental Services

93881

5637 N. Figarden Dr., Suite 104, Fresno, CA 93722 Phone: 559.274.9200 Fax: 559.274.9240 Email: LeonEnviro@comcast.net

Customer: **Wes ISAAC**

Company **Wes ISAAC CONSTRUCTION**

Date: **02/25/14**

Job No. **S25-14**

Analysis

PLM

Turn Around:

2hr Rush

Same Day

24hr

48hr

3-5 days

Inspection Site: **Cold Storage B206 Behind Reedley City Hall, 845 G. Street, Reedley, CA**

| Sample No | Location | Material | | | Quantity |
|-----------|--|----------|-----------------|--------|----------|
| | | Color | Type | Frable | |
| 01 | Main Detective Office Floor | Dark | 12x12 FT | | |
| 02 | " | Black | " " Mastic | | |
| 03 | North Detective Office Floor | | Carpet Adhesive | | |
| 04 | " | Brown | 9x9 FT | | |
| 05 | " | Black | " " Mastic | | |
| 06 | South Detective Office Floor | Grey | 9x9 FT | | |
| 07 | " | Black | " " Mastic | | |
| 08 | Break Room, Hallway + Restrooms Floor | Light | 12x12 FT | | |
| 09 | " | | " " Mastic | | |
| 10 | Main Detective Office Ceiling | | Tex/CC | | H1 |
| 11 | " | | Plaster | | |
| 12 | " Walls | | Tex/CC | | H1 |
| 13 | " | | Plaster | | |
| 14 | South Detective Office Walls + Ceiling | | Tex/CC | | H1 |
| 15 | " | | Plaster | | |
| 16 | Hallway to break Room Walls | | Tex | | H2 |
| 17 | " + Ceiling | | JC + SR Comp | | |
| 18 | Break Room Walls | | Tex | | H2 |
| 19 | " + Ceiling | | JC + SR Comp | | |
| 20 | Men's Restroom Walls + Ceiling | | Tex | | H2 |

Relinquished By

Date **2/25/14**

Received By

Date **2/26/14**

Leon Environmental Services

5637 N. Figarden Dr., Suite 104, Fresno, CA 93722 Phone: 559.274.9200 Fax: 559.274.9240 Email: LeonEnviro@comcast.net

Customer: Wes ISAAC Company Wes ISAAC CONST

Date: 02/25/14 Job No. 525

Analysis PLM Turn Around: 2hr Rush Same Day 24hr 48hr 3-5 days

Inspection Site: Cold Storage Bldg Behind Reedley City Hall 245 G ST, Reedley CA

| Sample No | Location | Material | | | Quantity |
|-----------|---|----------|------------------------------|--------|----------|
| | | Color | Type | Frable | |
| 21 | Mens Restroom Walls + Ceiling | | JC+SR Comp | | |
| 22 | Hallway Ceiling | | Aconstric Ceiling Spray | | |
| 23 | Break Room Ceiling | | " | | |
| 24 | " | | " | | |
| 25 | North Detective Office Ceiling | Fissures | 12x12 Aconstric Ceiling Tile | | |
| 26 | " | | " Adhesive | | |
| 27 | South Detective Office Ceiling | Holes | 12x12 A.C.T. | | |
| 28 | " | | " Adhesive | | |
| 29 | Break Room Base Cores | Brown | Base Core Adhesive | | |
| 30 | Warehouse Mens Restroom Walls + Ceiling | | Tex/CC | | H1 |
| 31 | " | | Plaster | | |
| 32 | Entry Room near landing docks - Floor | Tan | 12x12 FT | | |
| 33 | " | Black | " Mastic/Adhesive | | |
| 34 | " Walls + Ceiling | | Tex/Paint | | H3 |
| 35 | " | | " | | H3 |
| 36 | " | | JC+SR Comp | | |
| 37 | Storage Room 2 Walls + Ceiling | | Tex on Foam | | H4 |
| 38 | " | | " | | H4 |
| 39 | Storage Room 3 Walls + Ceiling | | " | | H4 |
| 40 | " | | " | | H4 |

Relinquished By: D. Leon Date: 2/25/14 Received By: JULIE W Date: 2/26/14

Leon Environmental Services

5637 N. Figarden Dr., Suite 104, Fresno, CA 93722 Phone: 559.274.9200 Fax: 559.274.9240 Email: LeonEnviro@comcast.net

Customer: **Wes ISAAC**

Company: **Wes ISAAC CONSTR.**

Date: **02/25/14**

Job No. **525-14**

Analysis

PLM

Turn Around:

2hr Rush

Same Day

24hr

48hr

3-5 days

Inspection Site: **Cold Storage Behind Reedley City Hall, 845 G. St., Reedley CA**

| Sample No | Location | Material | | | Quantity |
|-----------|------------------------------------|----------|-----------------------|---------|----------|
| | | Color | Type | Friable | |
| 41 | Storage Room 1 | | Tex on Foam | H4 | |
| 42 | West Hallway Walls | | Tex/CC | H5 | |
| 43 | " | | Plaster | | |
| 44 | North Hallway Walls | | Tex/CC | H5 | |
| 45 | " | | Plaster | | |
| 46 | Entry Room to North Hallway-Walls | | Tex/CC | H5 | |
| 47 | " | | Plaster | | |
| 48 | Storage Room 3 Walls | | Tex/CC | H5 | |
| 49 | " | | Plaster | | |
| 50 | South Hallway Walkunder Plywood | Brown | Drywall | H6 | |
| 51 | North Hallway Walkunder Plywood | Brown | " " | H6 | |
| 52 | Storage Room 1 Walls under Plywood | Brown | " " | H6 | |
| 53 | Storage Room 2 Wall Insulation | | Horse Hair Insulation | | |
| 54 | South Hallway Wall Insulation | | " " | | |
| 55 | Office Exterior Windows | | Window Putty | | |
| 56 | Exterior Stucco West Side | | Tex/CC | | |
| 57 | " | | Plaster | | |
| 58 | " East Side | | Tex/CC | | |
| 59 | " | | Plaster | | |
| 60 | " North Side | | Tex/CC | | |

Relinquished By

D. Lee

Date

2/25/14

Received By

duh ur

Date

2/26/14

Leon Environmental Services

5637 N. Figarden Dr., Suite 104, Fresno, CA 93722 Phone: 559.274.9200 Fax: 559.274.9240 Email: LeonEnviro@comcast.net

Customer: Wes ISAAC

Company Wes ISAAC CONST.

Date: 02/25/14

Job No. S25-14

Analysis

PLM

Turn Around:

2hr Rush

Same Day

24hr

48hr

3-5 days

Inspection Site: COLD STORAGE BLDG Behind Reedley City Hall, 845 G ST., Reedley CA

| Sample No | Location | Material | | | Quantity |
|-----------|----------------------------|----------|----------------------------|---------|----------|
| | | Color | Type | Friable | |
| 61 | Exterior Stucco North Side | | Plaster | | |
| 62 | " | | Vapor Barrier | | |
| 63 | West Barrel Roof Top Layer | | Asphalt Shingle Roof | | |
| 64 | " | | Under Layment | | |
| 65 | " 2nd Layer | | Asphalt Rolled Roofing | | |
| 66 | " | | Under Layment | | |
| 67 | " Remaining Layers | | Roofing Felts (All Layers) | | |
| 68 | " Seams + Vents | | Roof Mastic | | |
| 69 | East Roof Flat Roof | | Cap Sheet | | |
| 70 | " | | Roof Felts - All Layers | | |
| 71 | " Vents + Seams | | Roof Mastic | | |
| | | | | | |
| | | | | | |
| | | | | | |
| | | | | | |
| | | | | | |
| | | | | | |
| | | | | | |
| | | | | | |
| | | | | | |

Relinquished By D. Len

Date 2/25/14

Received By [Signature]

Date 2/26/14



WESTERN ANALYTICAL LABORATORY, Inc.
TEST REPORT

REPORT NO: 93881 CLIENT: Leon Environmental Services
 DATE COLLECTED: February 25, 2014 5637 N. Fig Garden Dr., Suite 104
 DATE RECEIVED: February 26, 2014 ATTENTION: Danny Leon
 DATE REQUIRED: March 3, 2014 (CAC 04-3708)
 REFERENCE: Job #S25-14
 Wes Isaac - Wes Isaac Construction
 Cold Storage Bldg. behind Reedley City Hall
 845 G. Street, Reedley, CA

SUBJECT: Polarized Light Microscopy Analysis for Asbestos; 73 samples
 METHODOLOGY: "Method for the Determination of Asbestos in Bulk Building Materials"
 (EPA 600/R-93/116)
 ACCREDITED: National Institute of Standards and Technology (NVLAP) # 200037

| SAMPLE ID NUMBER | SAMPLE LOCATION AND DESCRIPTION | NON-FIBROUS MATERIALS | OTHER FIBROUS MATERIALS | ASBESTIFORM MINERALS |
|------------------|--|----------------------------|-------------------------|----------------------|
| 01 | Main Detective Office Floor Dark 12x12 Floor tile | Granular Minerals Resin | None Detected | Chrysotile > 1% |
| 02 | Main Detective Office Floor Black mastic | Organics (tar) | None Detected | Chrysotile 3-4% |
| 03 | North Detective Office Floor Carpet Adhesive | Organics Clay Materials | None Detected | None Detected |
| 04 | North Detective Office Floor Brown 9x9 Floor tile | Granular Minerals Resin | None Detected | Chrysotile > 1% |

t: Trace > 1% = greater than 1% < 1 = less than 1%

Optical Microscopist

Mike Maladzhikyan, Laboratory Director

This report only applies to the sample(s) tested. Supporting laboratory documentation is available upon request. This report must not be reproduced except in full, unless approved by Western Analytical. The client is solely responsible for the use and interpretation of test results and reports requested from Western Analytical. This report must not be used by the client to claim product endorsement by NVLAP or any other agency of the U.S. Government.

Reference: Job # S25-14 / Wes Isaac - Wes Isaac Construction/
Cold Storage Bldg. behind Reedley City Hall, 845 G. Street, Reedley, CA

| SAMPLE ID NUMBER | SAMPLE LOCATION AND DESCRIPTION | NON-FIBROUS MATERIALS | OTHER FIBROUS MATERIALS | ASBESTIFORM MINERALS |
|------------------|---|---|-------------------------|----------------------|
| 05 | North Detective Office Floor Black Mastic | Organics (tar) | None Detected | None Detected |
| 06 | South Detective Office Floor Grey 9x9 Floor tile | Granular Minerals Resin | None Detected | Chrysotile >1% |
| 07 | South Detective Office Floor Black mastic | Organics (tar) | None Detected | None Detected |
| 08 | Break Room, Hallway and Restrooms Floor Light 12x12 Floor tile | Granular Minerals Resin | None Detected | None Detected |
| 09 | Break Room, Hallway and Restrooms Floor Black mastic | Organics (tar) | None Detected | None Detected |
| 10 | Main Detective Office Ceiling Texture/ color coat | Granular Minerals Organics Clay Materials | None Detected | None Detected |
| 11 | Main Detective Office Ceiling Plaster | Granular Minerals Gypsum | None Detected | None Detected |
| 12 | Main Detective Office Walls Texture/ color coat | Organics Clay Materials | None Detected | None Detected |

t: Trace >1% = greater than 1% <1 = less than 1%

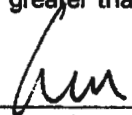

Optical Microscopist

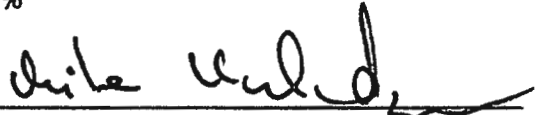

Mike Maladzhikyan, Laboratory Director

This report only applies to the sample(s) tested. Supporting laboratory documentation is available upon request. This report must not be reproduced except in full, unless approved by Western Analytical. The client is solely responsible for the use and interpretation of test results and reports requested from Western Analytical. This report must not be used by the client to claim product endorsement by NVLAP or any other agency of the U.S. Government.

Reference: Job # S25-14 / Wes Isaac - Wes Isaac Construction/
Cold Storage Bldg. behind Reedley City Hall, 845 G. Street, Reedley, CA

| SAMPLE ID NUMBER | SAMPLE LOCATION AND DESCRIPTION | NON-FIBROUS MATERIALS | OTHER FIBROUS MATERIALS | ASBESTIFORM MINERALS |
|------------------|--|---|-------------------------|----------------------|
| 13 | Main Detective Office Walls Plaster | Granular Minerals Gypsum | None Detected | None Detected |
| 14 | South Detective Office Walls and Ceiling Texture/ color coat | Granular Minerals Organics Clay Materials | None Detected | None Detected |
| 15 | South Detective Office Walls and Ceiling Plaster | Granular Minerals Gypsum | Cellulose <1% | None Detected |
| 16 | Hallway to Break Room Wall Texture | Granular Minerals Organics | None Detected | None Detected |
| 17 | Hallway to Break Room Wall Sheetrock and joint compound composite | Granular Minerals Gypsum | Cellulose 10% | None Detected |
| 18 | Break Room Walls Texture | Granular Minerals Organics | None Detected | None Detected |
| 19 | Break Room Walls and Ceiling Sheetrock and joint compound composite | Granular Minerals Gypsum | Cellulose 10% | None Detected |
| 20 | Men's Restroom Walls and Ceiling Texture | Granular Minerals Organics | None Detected | None Detected |

t: Trace >1% = greater than 1% <1 = less than 1%

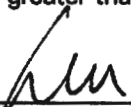
Optical Microscopist

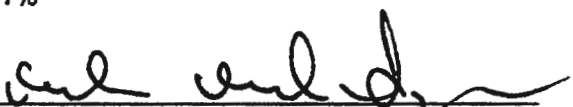
Mike Maladzhikyan, Laboratory Director

This report only applies to the sample(s) tested. Supporting laboratory documentation is available upon request. This report must not be reproduced except in full, unless approved by Western Analytical. The client is solely responsible for the use and interpretation of test results and reports requested from Western Analytical. This report must not be used by the client to claim product endorsement by NVLAP or any other agency of the U.S. Government.

Reference: Job # S25-14 / Wes Isaac - Wes Isaac Construction/
Cold Storage Bldg. behind Reedley City Hall, 845 G. Street, Reedley, CA

| SAMPLE ID NUMBER | SAMPLE LOCATION AND DESCRIPTION | NON-FIBROUS MATERIALS | OTHER FIBROUS MATERIALS | ASBESTIFORM MINERALS |
|------------------|---|--|---------------------------------|----------------------|
| 21 | Men's Restroom Walls and Ceiling Sheetrock and joint compound composite | Granular Minerals Gypsum | Cellulose 10% | None Detected |
| 22 | Hallway Ceiling Acoustic ceiling spray | Granular Minerals Organics | None Detected | None Detected |
| 23 | Break Room Ceiling Acoustic ceiling spray | Granular Minerals Organics | None Detected | None Detected |
| 24 | Break Room Ceiling Acoustic ceiling spray | Granular Minerals Organics | None Detected | None Detected |
| 25 | North Detective Office Ceiling Fissures 12x12 Acoustical ceiling tile | Granular Minerals Organics Perlite | Cellulose 60% Glass Wool 15% | None Detected |
| 26 | North Detective Office Ceiling Ceiling tile Adhesive | Organics Clay Materials | None Detected | None Detected |
| 27 | South Detective Office Ceiling Holes 12x12 Acoustical ceiling tile | Granular Minerals Organics | Cellulose 90% | None Detected |
| 28 | South Detective Office Ceiling Ceiling tile Adhesive | Organics Clay Materials | None Detected | None Detected |

t: Trace >1% = greater than 1% <1 = less than 1%

Optical Microscopist

Mike Maladzhikyan, Laboratory Director

This report only applies to the sample(s) tested. Supporting laboratory documentation is available upon request. This report must not be reproduced except in full, unless approved by Western Analytical. The client is solely responsible for the use and interpretation of test results and reports requested from Western Analytical. This report must not be used by the client to claim product endorsement by NVLAP or any other agency of the U.S. Government.

Reference: Job # S25-14 / Wes Isaac - Wes Isaac Construction/
Cold Storage Bldg. behind Reedley City Hall, 845 G. Street, Reedley, CA

| SAMPLE ID NUMBER | SAMPLE LOCATION AND DESCRIPTION | NON-FIBROUS MATERIALS | OTHER FIBROUS MATERIALS | ASBESTIFORM MINERALS |
|------------------|---|---|-------------------------|----------------------|
| 29 | Break Room Base Covs Brown base cove Adhesive | Granular Minerals Organics Clay Materials | Wollastonite 1-2% | None Detected |
| 30 | Warehouse Men's Restroom Walls and Ceiling Texture/ color coat | Granular Minerals Organics Clay Materials | None Detected | None Detected |
| 31 | Warehouse Men's Restroom Walls and Ceiling Plaster | Granular Minerals Gypsum | Cellulose <1% | None Detected |
| 32 | Entry Room near Landing Docks Floor Tan 12x12 Floor tile | Granular Minerals Resin | Cellulose 2% | None Detected |
| 33 | Entry Room near Landing Docks Floor Black mastic | Granular Minerals Organics Opagues | None Detected | None Detected |
| 34 | Entry Room near Landing Docks Walls and Ceiling Texture/ paint | Granular Minerals Organics | None Detected | None Detected |
| 35 | Entry Room near Landing Docks Walls and Ceiling Texture/ paint | Granular Minerals Organics | None Detected | None Detected |
| 36 | Entry Room near Landing Docks Walls and Ceiling Sheetrock and joint compound composite | Granular Minerals Gypsum | Cellulose 10% | None Detected |

t: Trace >1% = greater than 1% <1 = less than 1%

Optical Microscopist

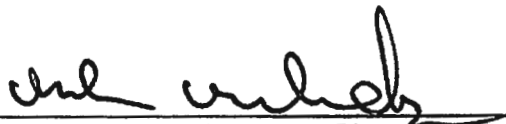
Mike Maladzhikyan, Laboratory Director

This report only applies to the sample(s) tested. Supporting laboratory documentation is available upon request. This report must not be reproduced except in full, unless approved by Western Analytical. The client is solely responsible for the use and interpretation of test results and reports requested from Western Analytical. This report must not be used by the client to claim product endorsement by NVLAP or any other agency of the U.S. Government.

Reference: Job # S25-14 / Wes Isaac - Wes Isaac Construction/
Cold Storage Bldg. behind Reedley City Hall, 845 G. Street, Reedley, CA

| SAMPLE ID NUMBER | SAMPLE LOCATION AND DESCRIPTION | NON-FIBROUS MATERIALS | OTHER FIBROUS MATERIALS | ASBESTIFORM MINERALS |
|------------------|---|---|-------------------------|----------------------|
| 37 | Storage Room 2 Walls and Ceiling Texture on foam | Granular Minerals Organics Diatoms Perlite | None Detected | Chrysotile 2% |
| 38 | Storage Room 2 Walls and Ceiling Texture on foam | Granular Minerals Organics Diatoms Perlite | None Detected | Chrysotile 2% |
| 39 | Storage Room 3 Walls and Ceiling Texture on foam | Granular Minerals Organics Diatoms Perlite | None Detected | Chrysotile 2% |
| 40 | Storage Room 3 Walls and Ceiling Texture on foam | Granular Minerals Organics Diatoms Perlite | None Detected | Chrysotile 2% |
| 41 | Storage Room 1 Texture on foam | Granular Minerals Organics Diatoms Perlite | None Detected | Chrysotile 2% |
| 42 | West Hallway Walls Texture/ color coat | Granular Minerals Organics | None Detected | None Detected |
| 43 | West Hallway Walls Plaster | Granular Minerals Mortar | None Detected | None Detected |
| 44 | North Hallway Walls Texture/ color coat | Granular Minerals Organics | None Detected | None Detected |

t: Trace > 1% = greater than 1% < 1 = less than 1%

Optical Microscopist

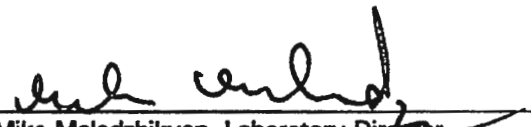
Mike Maladzhikyan, Laboratory Director

This report only applies to the sample(s) tested. Supporting laboratory documentation is available upon request. This report must not be reproduced except in full, unless approved by Western Analytical. The client is solely responsible for the use and interpretation of test results and reports requested from Western Analytical. This report must not be used by the client to claim product endorsement by NVLAP or any other agency of the U.S. Government.

Reference: Job # S25-14 / Wes Isaac - Wes Isaac Construction/
Cold Storage Bldg. behind Reedley City Hall, 845 G. Street, Reedley, CA

| SAMPLE ID NUMBER | SAMPLE LOCATION AND DESCRIPTION | NON-FIBROUS MATERIALS | OTHER FIBROUS MATERIALS | ASBESTIFORM MINERALS |
|------------------|---|-------------------------------|----------------------------------|----------------------|
| 45 | North Hallway Walls Plaster | Granular Minerals Mortar | None Detected | None Detected |
| 46 | Entry Room to North Hallway Walls Texture / color coat | Granular Minerals Organics | None Detected | None Detected |
| 47 | Entry Room to North Hallway Walls Plaster | Granular Minerals Mortar | None Detected | None Detected |
| 48 | Storage Room 3 Walls Texture/ color coat | Granular Minerals Organics | None Detected | None Detected |
| 49 | Storage Room 3 Walls Plaster | Granular Minerals Mortar | None Detected | None Detected |
| 50 | South Hallway Walls under Plywood Brown drywall | Granular Minerals Gypsum | Cellulose 10% Fiberglass 2% | None Detected |
| 51 | North Hallway Walls under Plywood Brown drywall | Granular Minerals Gypsum | Cellulose 10% Fiberglass 1-2% | None Detected |
| 52 | Storage Room 1 Walls under Plywood Brown drywall | Granular Minerals Gypsum | Cellulose 10% Fiberglass 2% | None Detected |

t: Trace > 1% = greater than 1% < 1 = less than 1%

Optical Microscopist

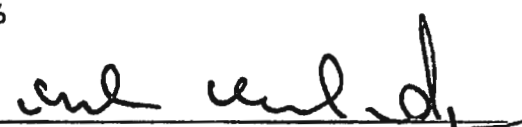
Mike Maladzhikyan, Laboratory Director

This report only applies to the sample(s) tested. Supporting laboratory documentation is available upon request. This report must not be reproduced except in full, unless approved by Western Analytical. The client is solely responsible for the use and interpretation of test results and reports requested from Western Analytical. This report must not be used by the client to claim product endorsement by NVLAP or any other agency of the U.S. Government.

Reference: Job # S25-14 / Wes Isaac - Wes Isaac Construction/
Cold Storage Bldg. behind Reedley City Hall, 845 G. Street, Reedley, CA

| SAMPLE ID NUMBER | SAMPLE LOCATION AND DESCRIPTION | NON-FIBROUS MATERIALS | OTHER FIBROUS MATERIALS | ASBESTIFORM MINERALS |
|------------------|---|---|-------------------------|----------------------|
| 53 | Storage Room 2 Wall insulation Horse hair insulation | Organics | Cellulose 80% | None Detected |
| 54 | South Hallway Wall Insulation Horse hair insulation | Organics | Cellulose 80% | None Detected |
| 55 | Office Exterior Windows Window putty | Granular Minerals | None Detected | None Detected |
| 56 | Exterior Stucco West Side Texture/ color coat | Granular Minerals Mortar | None Detected | None Detected |
| 57 | Exterior Stucco West Side Plaster | Granular Minerals Mortar | None Detected | None Detected |
| 58 | Exterior Stucco East Side Texture/ color coat | Granular Minerals Organics Mortar | None Detected | None Detected |
| 59 | Exterior Stucco East Side Plaster | Granular Minerals Mortar | None Detected | None Detected |
| 60 | Exterior Stucco North Side Texture/ color coat | Granular Minerals Organics Mortar | None Detected | None Detected |

t: Trace >1% = greater than 1% <1 = less than 1%

Optical Microscopist

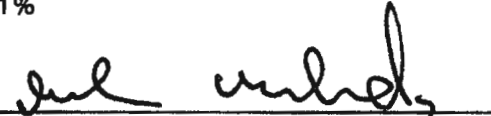
Mike Maladzhikyan, Laboratory Director

This report only applies to the sample(s) tested. Supporting laboratory documentation is available upon request. This report must not be reproduced except in full, unless approved by Western Analytical. The client is solely responsible for the use and interpretation of test results and reports requested from Western Analytical. This report must not be used by the client to claim product endorsement by NVLAP or any other agency of the U.S. Government.

Reference: Job # S25-14 / Wes Isaac - Wes Isaac Construction/
Cold Storage Bldg. behind Reedley City Hall, 845 G. Street, Reedley, CA

| SAMPLE ID NUMBER | SAMPLE LOCATION AND DESCRIPTION | NON-FIBROUS MATERIALS | OTHER FIBROUS MATERIALS | ASBESTIFORM MINERALS |
|------------------|--|-------------------------------------|-------------------------|----------------------|
| 61 | Exterior Stucco North Side Plaster | Granular Minerals Mortar | None Detected | None Detected |
| 62 | Exterior Stucco North Side Vapor barrier | Organics (tar) | Cellulose 50% | None Detected |
| 63 | West Barrel Roof, Top layer Asphalt shingle roof | Granular Minerals Organics (tar) | Fiberglass 2% | None Detected |
| 64 | West Barrel Roof, Top layer Underlayment | Granular Minerals Organics (tar) | Cellulose 50% | None Detected |
| 65 | West Barrel Roof, 2 nd layer Asphalt shingle roof | Granular Minerals Organics (tar) | Fiberglass 2% | None Detected |
| 66a | West Barrel Roof, 2 nd layer, layer 1 Roofing | Granular Minerals Organics (tar) | Fiberglass 1-2% | None Detected |
| 66b | West Barrel Roof, 2 nd layer, layer 2 Underlayment | Granular Minerals Organics (tar) | Cellulose 50% | None Detected |
| 67a | West Barrel Roof, Remaining layers Roofing | Granular Minerals Organics (tar) | None Detected | Chrysotile 40% |

t: Trace > 1% = greater than 1% < 1 = less than 1%

Optical Microscopist

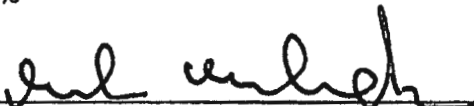

Mike Maladzhikyan, Laboratory Director

This report only applies to the sample(s) tested. Supporting laboratory documentation is available upon request. This report must not be reproduced except in full, unless approved by Western Analytical. The client is solely responsible for the use and interpretation of test results and reports requested from Western Analytical. This report must not be used by the client to claim product endorsement by NVLAP or any other agency of the U.S. Government.

Reference: Job # S25-14 / Wes Isaac - Wes Isaac Construction/
Cold Storage Bldg. behind Reedley City Hall, 845 G. Street, Reedley, CA

| SAMPLE ID NUMBER | SAMPLE LOCATION AND DESCRIPTION | NON-FIBROUS MATERIALS | OTHER FIBROUS MATERIALS | ASBESTIFORM MINERALS |
|------------------|---|-------------------------------------|---------------------------------|----------------------|
| 67b | West Barrel Roof, Remaining layers Roofing | Granular Minerals Organics (tar) | None Detected | Chrysotile 40% |
| 68 | West Barrel Roof, Seams and Vents Roof mastic | Granular Minerals Organics (tar) | None Detected | Chrysotile 10% |
| 69 | East Roof Flat Roof Cap sheet | Granular Minerals Organics (tar) | Cellulose 5% Fiberglass <1% | None Detected |
| 70 | East Roof Flat Roof Roof felt | Granular Minerals Organics (tar) | Cellulose 10% Fiberglass <1% | None Detected |
| 71 | East Roof Flat Roof Vents and Seams Roof mastic | Granular Minerals Organics (tar) | Cellulose 5% | None Detected |

t: Trace >1% = greater than 1% <1 = less than 1%



Optical Microscopist

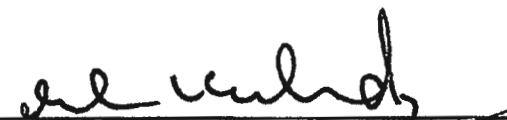

Mike Maladzhikyan, Laboratory Director

This report only applies to the sample(s) tested. Supporting laboratory documentation is available upon request. This report must not be reproduced except in full, unless approved by Western Analytical. The client is solely responsible for the use and interpretation of test results and reports requested from Western Analytical. This report must not be used by the client to claim product endorsement by NVLAP or any other agency of the U.S. Government.

Leon Environmental Services

Richard "Danny" Leon CAC Certification No. 04-3708
Tommy Leon CAC Certification No. 05-3882

Job S25-14 Sample Location Diagram Overview
Cold Storage Building / 845 G. St, Reedley, CA
Wes Isaac / Wes Isaac Construction
Drawing not to Scale

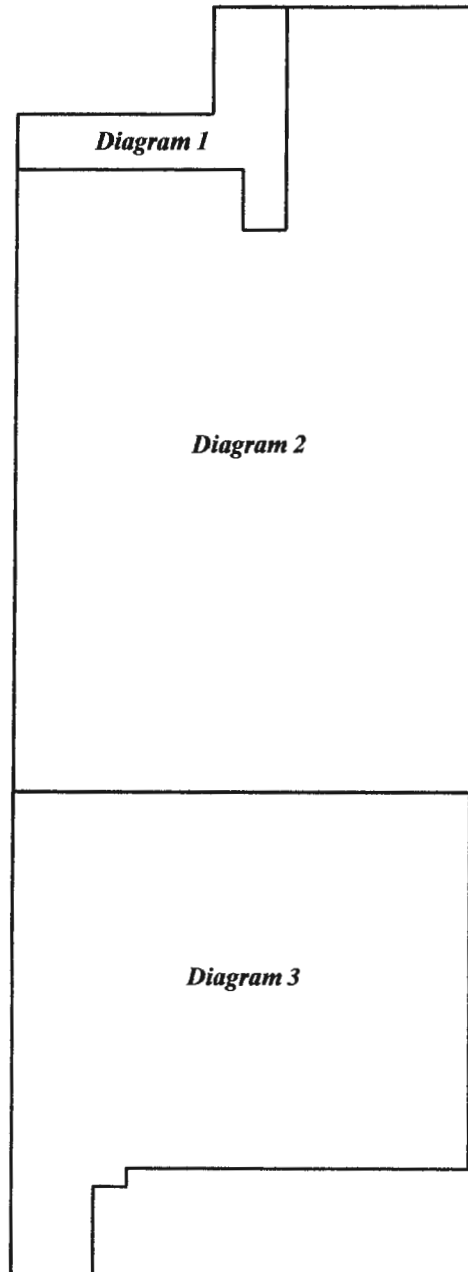

Y = Exterior Samples
X = Interior Samples
R = Roof Samples



Leon Environmental Services

Richard "Danny" Leon CAC Certification No. 04-3708
Tommy Leon CAC Certification No. 05-3882

Job S25-14 Sample Location Diagram 1
Cold Storage Building / 845 G. St, Reedley, CA
Wes Isaac / Wes Isaac Construction
Drawing not to Scale

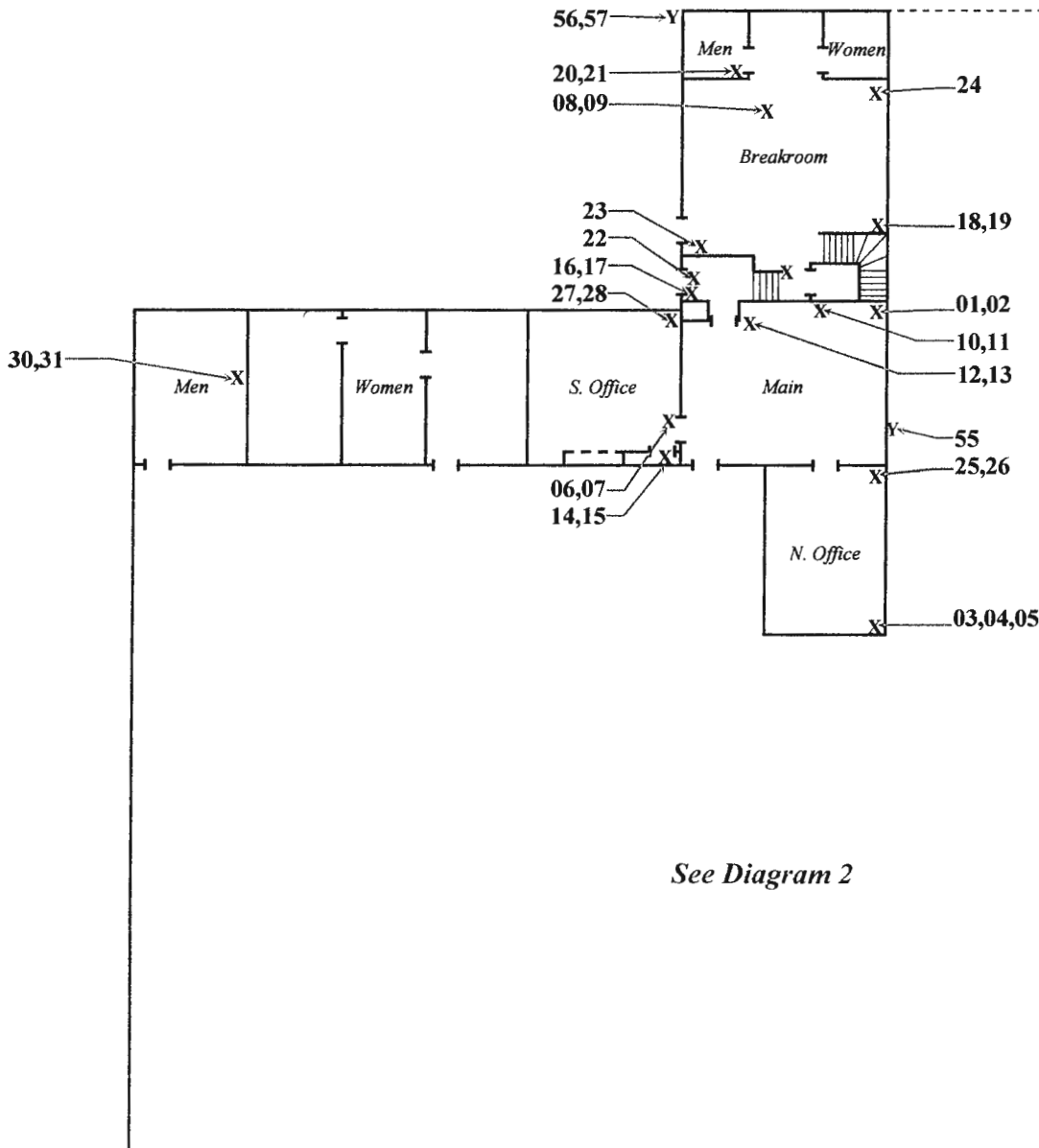

Y = Exterior Samples
X = Interior Samples
R = Roof Samples



Leon Environmental Services

Richard "Danny" Leon CAC Certification No. 04-3708
Tommy Leon CAC Certification No. 05-3882

Job S25-14 Sample Location Diagram 2
Cold Storage Building / 845 G. St, Reedley, CA
Wes Isaac / Wes Isaac Construction
Drawing not to Scale

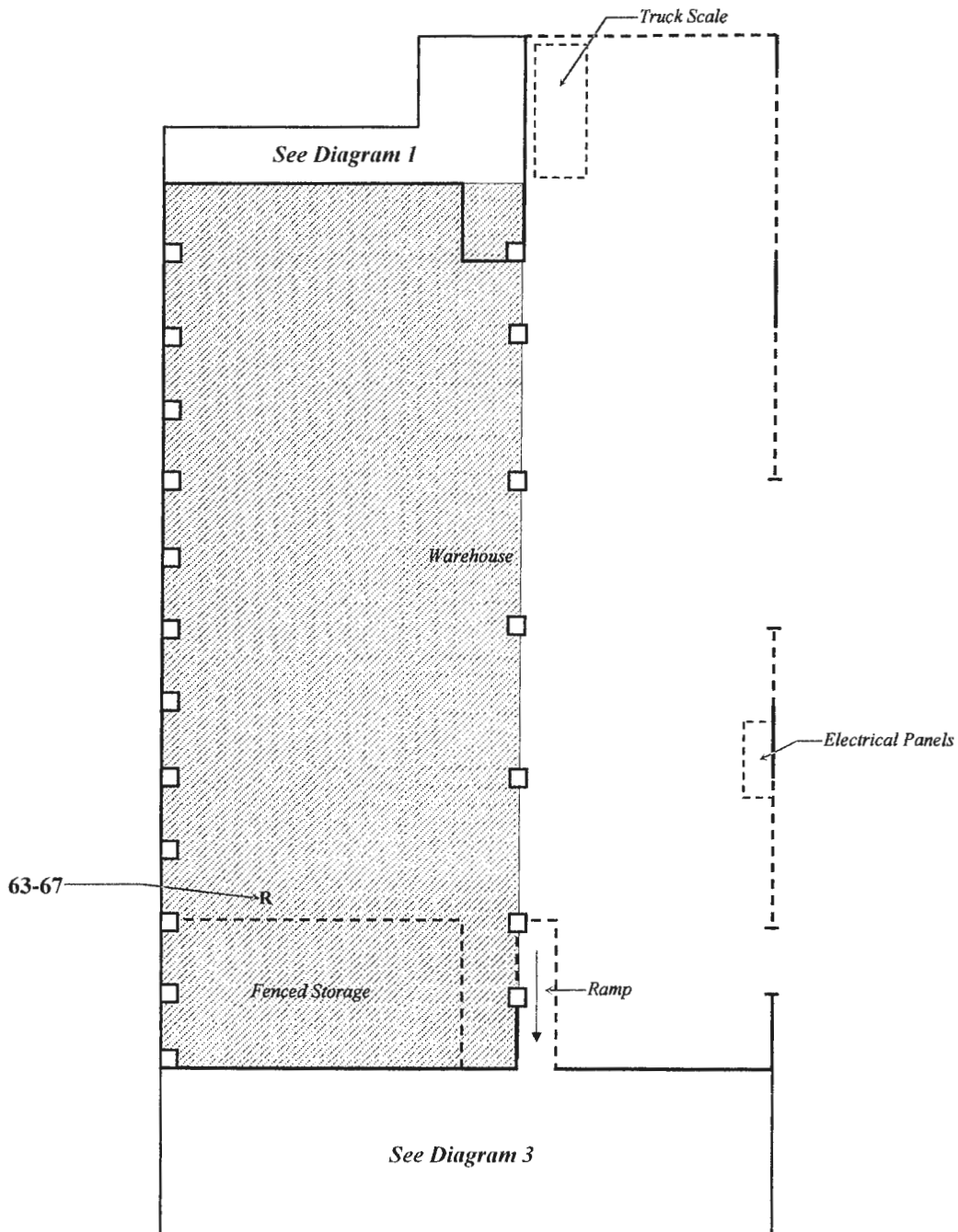

- Y = Exterior Samples
- X = Interior Samples
- R = Roof Samples
- ☐ = ACM Barreled Roof



Leon Environmental Services

Richard "Danny" Leon CAC Certification No. 04-3708
 Tommy Leon CAC Certification No. 05-3882

Job S25-14 Sample Location Diagram 3
Cold Storage Building / 845 G. St, Reedley, CA
Wes Isaac / Wes Isaac Construction
Drawing not to Scale

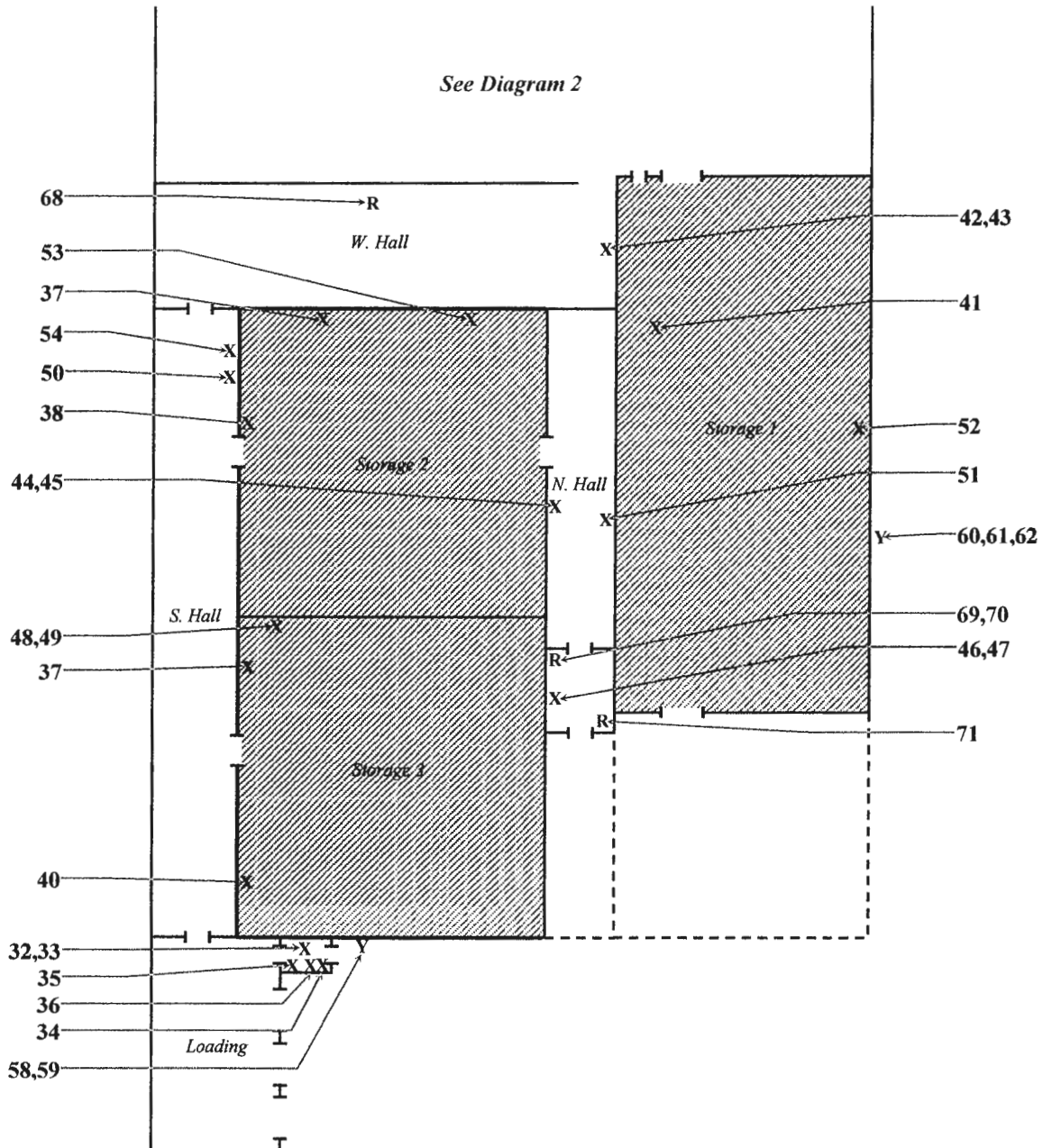

- Y = Exterior Samples
- X = Interior Samples
- R = Roof Samples
- = ACM Walls
- ▨ = ACM Ceiling

